

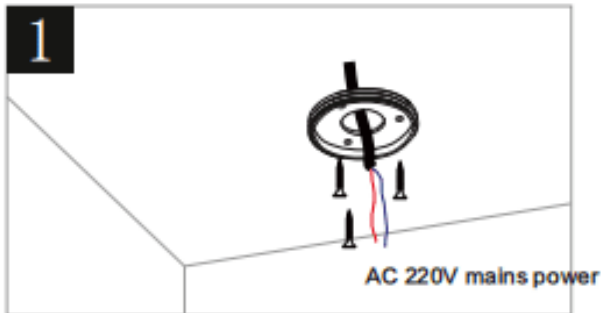

- Installation and wiring of luminaire must be in accordance with all applicable local codes.
- Installation, inspection, and maintenance of luminaires should be performed by a qualified electrician.
- DO NOT make or alter any open holes in the luminaire. Do not modify the luminaire.
- DO NOT install damaged product.
- Make sure electrical power is OFF before and during installation and maintenance.
- Make sure the equipment is properly grounded.
- Make sure the supply voltage is same as the rated fixture voltage.

Ceiling-mounted installation



Attach the ceiling rose to the ceiling using the provided screws.

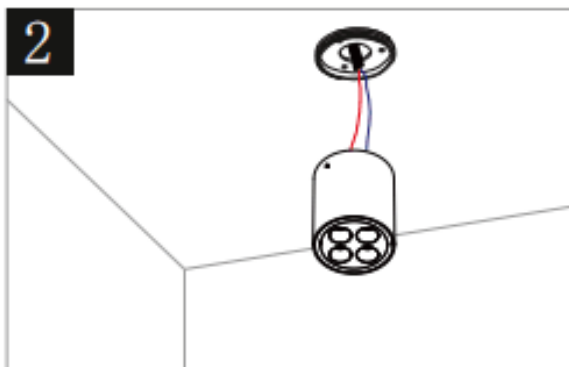

Connect the reserved wires to the lamp's power supply, then tighten the lamp to the ceiling mount.

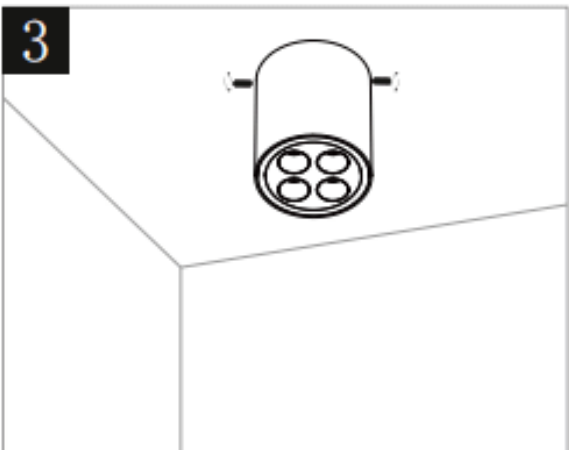

Use the screws provided with the fixture to secure the light to the ceiling.

After installation, turn on the power to check if the light works.

Wall-mounted installation method

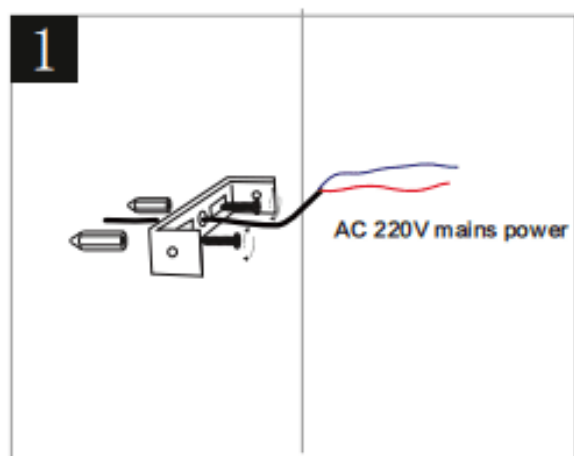

Install the mounting plate on the ceiling with the provided screws, leaving space for the power supply wires.

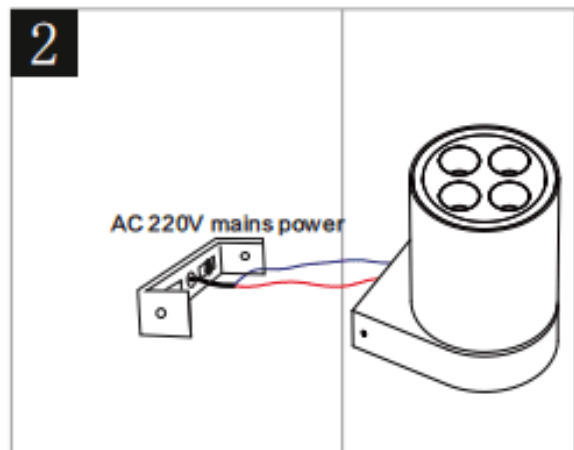

Connect the reserved power supply wire to the lighting fixture power wire

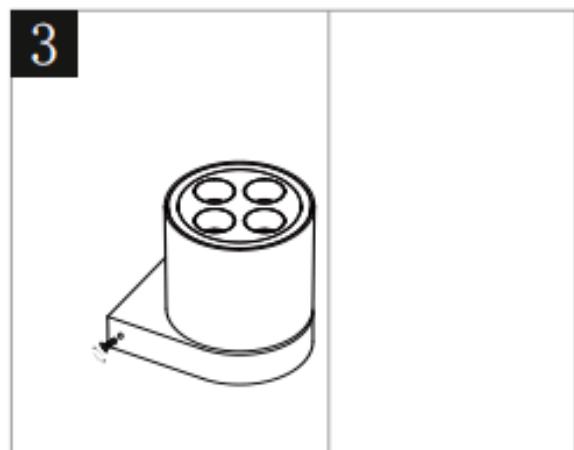

Use the screws provided with the fixture to secure the light to the ceiling. After installation, turn on the power to check if the light works.